

Adjustable Hand Levers

Zinc Die Casting, Insert Steel, with Internal Thread / with External Thread, with Increased Clamping Force

SPECIFICATION

Handle

Zinc die casting

- Powder coated
 - Black, RAL 9005, textured finish **SW**
 - Black, RAL 9005, silk finish **SZ**
 - Orange, RAL 2004, textured finish **OS**
 - Red, RAL 3000, textured finish **RS**
 - Silver, RAL 9006, textured finish **SR**
- Chrome plated **CR**

- Axial bearing / Insert
Nitrided, blackened
- Retaining screw
Blackened

Pressure spring

Stainless steel AISI 301



INFORMATION

Adjustable hand levers GN 300.4 are produced with a clamping area which is linked via a thrust ball bearing (axial bearing) to the insert of the hand lever.

This has led to the following advantages:

- Doubled clamping force through vastly reduced friction.
- There is no movement on the contact area between adjustable hand lever and component which greatly reduces any marking on the clamping area.
- In addition a reduced creep factor has been achieved by the increased preload.

TECHNICAL INFORMATION

- Stainless Steel Characteristics (see page A26)

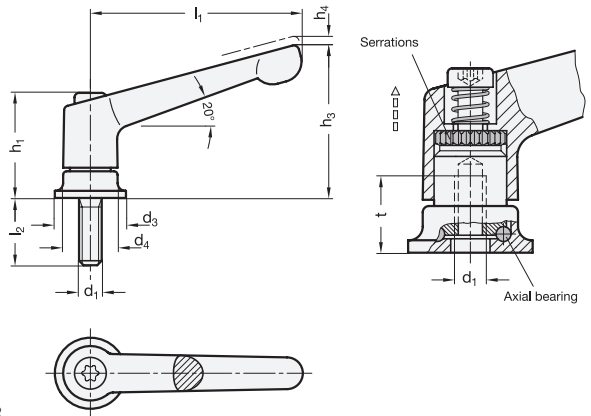

* Complete with



GN 300.4-With internal thread

Description	l ₁	d ₁	d ₃	d ₄	h ₁	h ₃	h ₄ Stroke	t min.	⚖
GN 300.4-63-M6-*	63	M 6	24	17.5	34.5	48.5	4	12.5	94
GN 300.4-78-M8-*	78	M 8	25	21	39.5	58.5	4	14	142
GN 300.4-92-M10-*	92	M 10	30	24	46.5	68.5	4	18	207
GN 300.4-108-M12-*	108	M 12	35	30	56.5	82	5	26.5	352

GN 300.4-With external thread

Description	l ₁	d ₁	l ₂ ≈	d ₃	d ₄	h ₁	h ₃	h ₄ Stroke	⚖
GN 300.4-63-M6-20-*	63	M 6	20	24	17.5	34.5	48.5	4	100
GN 300.4-63-M6-27-*	63	M 6	27	24	17.5	34.5	48.5	4	99
GN 300.4-78-M8-21-*	78	M 8	21	25	21	39.5	58.5	4	155
GN 300.4-78-M8-36-*	78	M 8	36	25	21	39.5	58.5	4	160
GN 300.4-92-M10-29-*	92	M 10	29	30	24	46.5	68.5	4	233
GN 300.4-92-M10-47-*	92	M 10	47	30	24	46.5	68.5	4	242
GN 300.4-108-M12-34-*	108	M 12	34	35	30	56.5	82	5	303
GN 300.4-108-M12-50-*	108	M 12	50	35	30	56.5	82	5	411
GN 300.4-108-M12-57-*	108	M 12	57	35	30	56.5	82	5	434
GN 300.4-108-M12-65-*	108	M 12	65	35	30	56.5	82	5	424
GN 300.4-108-M12-85-*	108	M 12	85	35	30	56.5	82	5	439

Weight SW